

Electrical Package 148WB, 159WB

\$5,949.52 (Installed Price Before Tax)

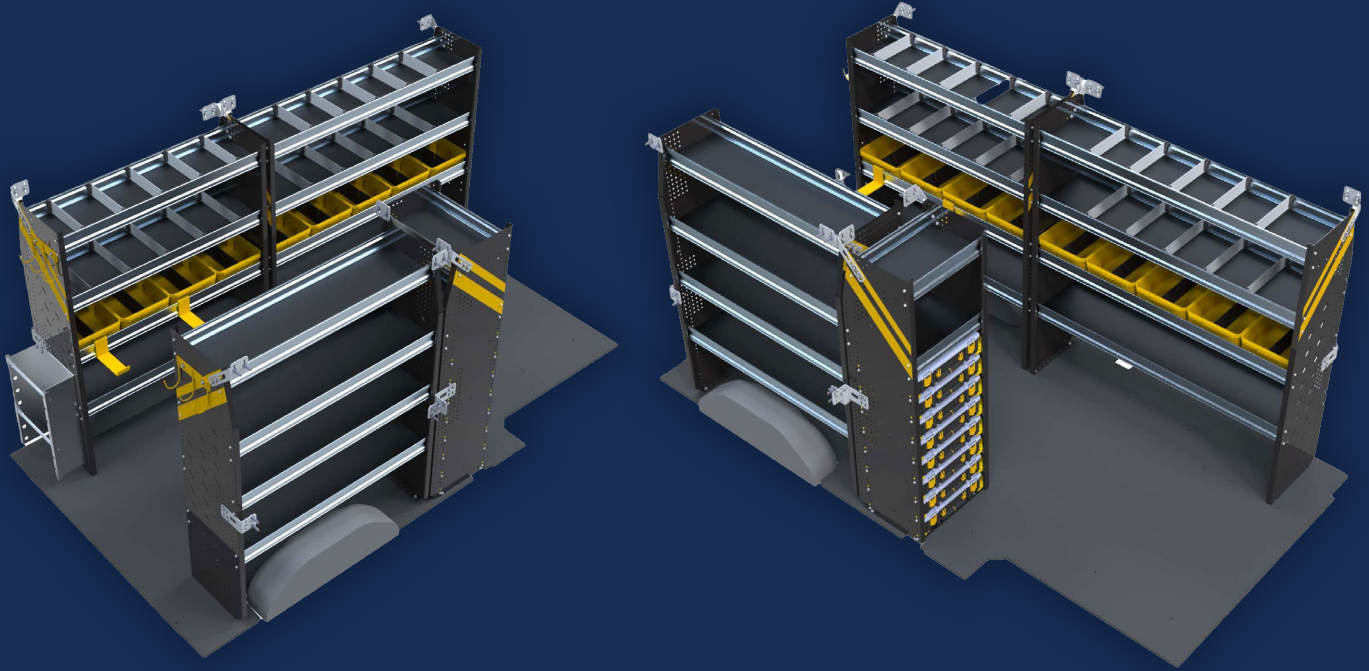

What's Included

PART #	DESCRIPTION	QTY
N5-RS60-4	Steel Shelving Unit for High Roof Van, 16" x 62" x 60"	1
N5-RS48-4	Steel Shelving Unit for High Roof Van, 16" x 62" x 48"	2
N5-PS20-8	Partskeeper Cabinet With 8 Carry Cases & 2 Shelves, 16"D X 20"W X 62 H"	2
62-UDR12	5-Pack, Regular Divider With Clips, 12" Depth	2
62-UDR14	Set of 5 Adjustable Dividers for a 14" Deep Shelf	2
62-U1114	14" Deep Plastic Bin With a Center Divider	9
7124	Reel Holder With Two 5/8" Dia Rods, Aluminum, 7 1/4"D X 15"W X 24"H	1
6073	Large Movable Hook, Painted Yellow, 2 3/4"W X 4"H, 6 1/2" Opening	2
6071	Bar With Three 6" Hooks, Painted Yellow, 3" Opening	2

Note: Ladder racks and partitions are not included but are available. [See our add-ons](#) for options and pricing. Flooring and liners are not included. Contact us for options and pricing.

Compatible Van Models

Ford Transit Mid-Roof 148" Wheelbase
Ford Transit Mid-Roof 148" Extended Wheelbase
Ford Transit High Roof 148" Wheelbase
Ford Transit High Roof 148" Extended Wheelbase

RAM ProMaster Mid-Roof 159" Wheelbase
RAM ProMaster Mid-Roof 159" Extended Wheelbase
RAM ProMaster High Roof 159" Wheelbase
RAM ProMaster High Roof 159" Extended Wheelbase

PROTECH
WORK LIKE A PRO

RANGER
DESIGN

ProTechCB.com
(712) 328-1310
4343 South 19th Street
Council Bluffs, IA 51501

